

# Accessories

## Pressure Gauge Snubber Model 910.12, Brass, Steel or Stainless Steel



### Applications

- Pressure gauge snubbers are intended to suppress the effect of pressure pulses and pressure peaks
- Stainless steel version for corrosive pressure media, even in corrosive ambience
- Process industry: mechanical engineering and plant construction, chemical/petrochemical, power stations, mining, on-and offshore, environmental technology

### Special Features

- Max. temperature 120°C
- Nominal pressures up to 400 bar

### Description

The pressure gauge snubber is provided with an adjustable needle valve that enables to restrict the flow as operating conditions may demand even if the snubber is in service. The carefully adjusted snubber will considerably increase the service life of pressure gauges at arduous conditions such as found at reciprocating pumps and compressors, hydraulic presses or fluid power systems and will additionally improve the reading accuracy of the fitted gauge.

### Standard Features

#### Pressure connection

G 1/2 male / female per EN 837-1 / 7.3



Pressure gauge snubber,  
Model 910.12

Material Body	Spindle	Sealing	PN bar	Temperature range	Order No.
Brass	1.4404 <sup>2)</sup>	NBR	250	-10 ... +120 °C	9090185
Steel <sup>1)</sup>	1.4404 <sup>2)</sup>	NBR	400	-10 ... +120 °C	9090193
1.4571 <sup>2)</sup>	1.4404 <sup>2)</sup>	FPM	400	-10 ... +120 °C	9091262

1) rustproof 2) stainless steel



ENGINEERING YOUR SUCCESS.

## Options

- Materials: chromed brass  
Monel®
- Pressure connection: G 1/4, G 3/8 per EN 837-1/7.3  
M20 x 1.5  
1/4 NPT, 1/2 NPT
- Degreased for oxygen, max. 50 bar / +60°C  
(for brass and stainless steel 1.4571 only)
- Acceptance test certificate DIN 50 049 / EN 10 204 3.1

## Dimensions in mm

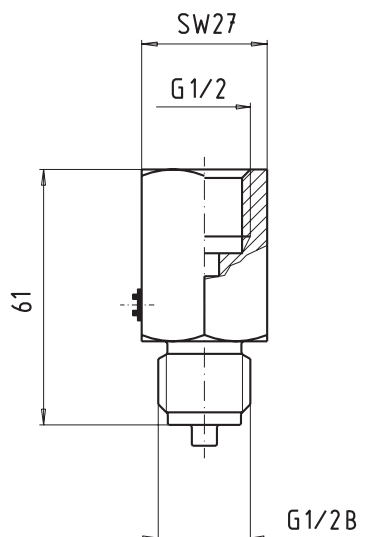

## Operating principle

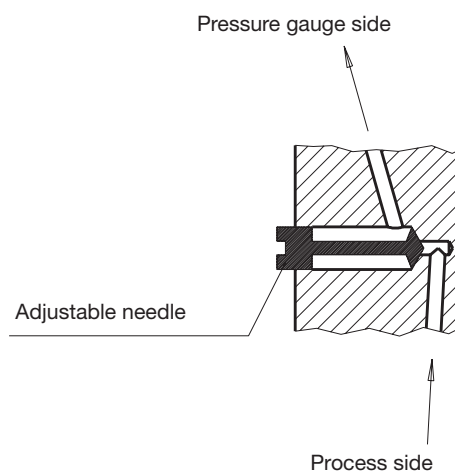

## Ordering information - Part Number Configurator

	Part Code	Material	Connection	Options
Example	PGS	Brass	4R	C of C
		<div>Brass = B</div> <div>Steel = S</div> <div>Stainless = 316</div>	<div>1/4" BSP = 4R</div> <div>1/2" BSP = 8R</div> <div>1/4" NPT = 4N</div> <div>1/2" NPT = 8N</div>	<div>C of C</div> <div>Certs 3.1</div>

Modifications may take place and materials specified may be replaced by others without prior notice.  
Specifications and dimensions given in this leaflet represent the state of engineering at the time of printing.