

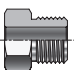

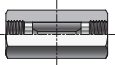

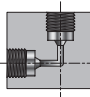



High Pressure Fitting

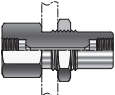
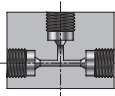

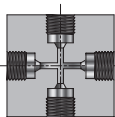
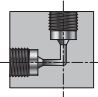
High Pressure Fitting Index

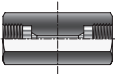
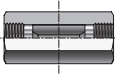
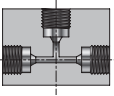
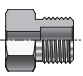
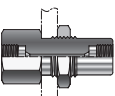
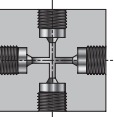
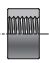
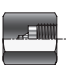
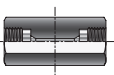
Medium Pressure Fittings								
	SMPG Gland	3P		SMPUC Union Coupling (Slip Type)	5P		SHPE Elbow	9P
	SMPCR Collar	4P		SMPBC Bulkhead coupling	5P		SHPT Tee	10P
	SMPP Plug	4P		SMPCP Cap	6P		SHPC Cross	10P
	SMPE Elbow	4P		SMPN Nipple	6P		SHPSC Straight Coupling	10P
			High Pressure Fittings				SHPUC Union Coupling (Slip Type)	11P
	SMPT Tee	4P		SHPG Gland	8P		SHPBC Bulkhead coupling	11P
	SMPC Cross	5P		SHPCR Collar	9P		SHPCP Cap	11P
	SMPSC Straight Coupling	5P		SHPP Plug	9P		SHPN Nipple	12P

Medium Pressure Fittings

SMP Series - 20,000 psi (1380 bar)

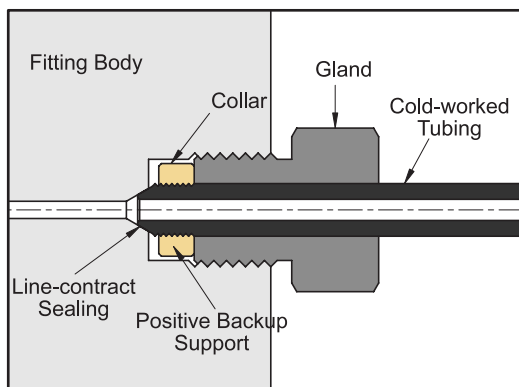

Features

- Pressure: up to 20,000psi (1380 bar)
- Coned and Threaded connection.
- Available sizes: 1/4", 3/8", 9/16", 3/4", and 1" .
- Fittings manufactured from cold worked 316 stainless steel.
- Operating temperatures: -423°F (-252°C) to 1200°F (649°C)

Tube Size & End Dimension

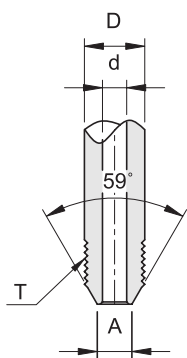

Tube Size, mm				Flow Area mm ²	Working Pressure, psi				
O.D (D)	I.D (d)	A	Thread (T)		-325 to 100°F (-198 to 37.8°C)	200°F (93°C)	400°F (204°C)	600°F (316°C)	800°F (427°C)
1/4" (6.35)	2.77	3.57	1/4" - 28 L.H.	5.81	20,000	20,000	19,250	18,050	16,800
3/8" (9.53)	5.16	6.35	3/8" - 24 L.H.	20.65	20,000	20,000	19,250	18,050	16,800
9/16" (14.29)	7.92	10.32	9/16" - 18 L.H.	49.03	20,000	20,000	19,250	18,050	16,800
	9.12			65.16	15,000	15,000	14,400	13,650	12,670
3/4" (19.05)	11.13	14.29	3/4" - 16 L.H.	97.42	20,000	20,000	19,250	18,050	16,800
	13.11			134.84	15,000	15,000	14,400	13,650	12,670
1" (25.40)	14.27	18.26	1" - 14 L.H.	160.00	20,000	20,000	19,250	18,050	16,800
	17.48			239.35	15,000	15,000	14,400	13,650	12,670

SMPG

Gland

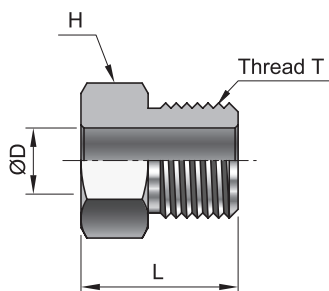

Part No.	Tube Size (in)	Hex H(in)	D	L	Thread T	Pressure Rating (psi)
SMPG- 4H	1/4"	1/2"	6.4	17.5	7/16" - 20 UNF	20,000
SMPG- 6H	3/8"	5/8"	9.5	20.6	9/16" - 18 UNF	20,000
SMPG- 9H	9/16"	7/8"	14.3	27.0	13/16" - 16 UNF	20,000
SMPG-12H	3/4"	1-1/8"	19.1	28.6	3/4" - 14 NPSM	20,000
SMPG-16H	1"	1-3/8"	25.4	38.1	1-3/8" - 12 UNF	20,000

SMPCR

Collar

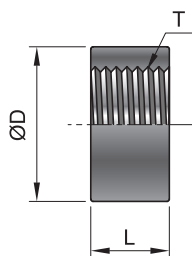

Part No.	Tube Size (in)	D	L	Thread T	Pressure Rating (psi)
SMPCR- 4H	1/4"	9.5	5.6	1/4" - 28 L.H.	20,000
SMPCR- 6H	3/8"	11.9	6.4	3/8" - 24 L.H.	20,000
SMPCR- 9H	9/16"	18.3	7.9	9/16" - 18 L.H.	20,000
SMPCR-12H	3/4"	23.8	9.5	3/4" - 16 L.H.	20,000
SMPCR-16H	1"	31.8	12.7	1" - 14 L.H.	20,000

SMPP

Plug

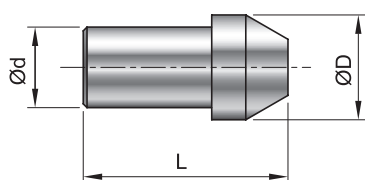

Part No.	Tube Size (in)	d	D	L	Pressure Rating (psi)
SMPP- 4H	1/4"	6.4	9.5	25.4	20,000
SMPP- 6H	3/8"	9.5	11.9	31.8	20,000
SMPP- 9H	9/16"	14.3	18.3	39.7	20,000
SMPP-12H	3/4"	19.1	23.9	44.5	20,000
SMPP-16H	1"	25.4	31.8	60.3	20,000

SMPE

Elbow

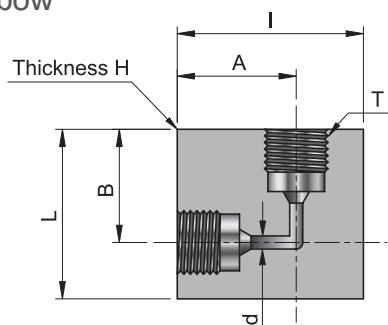

Part No.	Tube Size (in)	d	A	B	I	L	H	T	Pressure Rating (psi)
SMPE - 4H	1/4"	3.2	22.2	17.5	30.2	25.4	15.9	7/16" - 20 UNF	20,000
SMPE - 6H	3/8"	5.6	25.4	25.4	34.9	34.9	19.1	9/16" - 18 UNF	20,000
SMPE - 9H	9/16"	9.1	31.8	31.8	44.5	44.5	25.4	13/16" - 16 UNF	20,000
SMPE -12H	3/4"	13.1	38.1	38.1	57.2	57.2	34.9	3/4" - 14 NPSM	20,000
SMPE -16H	1"	17.5	52.4	52.4	76.2	76.2	44.5	1-3/8" - 12 UNF	20,000

SMPT

Tee

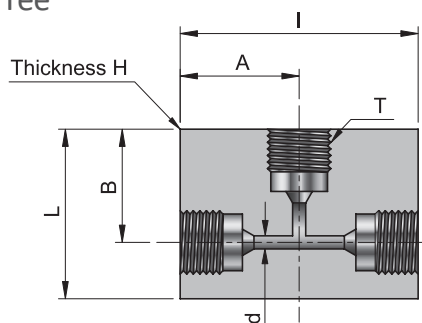

Part No.	Tube Size (in)	d	A	B	I	L	H	T	Pressure Rating (psi)
SMPT - 4H	1/4"	3.2	22.2	17.5	44.5	25.4	15.9	7/16" - 20 UNF	20,000
SMPT - 6H	3/8"	5.6	25.4	25.4	50.8	34.9	19.1	9/16" - 18 UNF	20,000
SMPT - 9H	9/16"	9.1	31.8	31.8	63.5	44.5	25.4	13/16" - 16 UNF	20,000
SMPT -12H	3/4"	13.1	38.1	38.1	76.2	57.2	34.9	3/4" - 14 NPSM	20,000
SMPT -16H	1"	17.5	52.4	52.4	104.8	76.2	44.5	1-3/8" - 12 UNF	20,000

- Dimensions and Drawings are for reference only and are subject to change without prior notice.
- Unless otherwise specified, all dimensions are in millimeters.
- Sizes, pressure classes, and end connections not listed are available upon request.
- Dimensions shown with SUPERLOK nuts finger-tight, where applicable.

SMPC

Cross

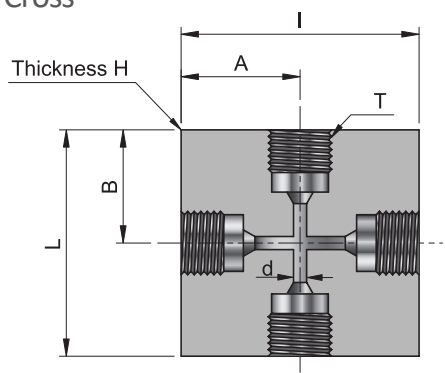

Part No.	Tube Size (in)	d	A	B	I	L	H	T	Pressure Rating (psi)
SMPC - 4H	1/4"	3.2	22.2	17.5	44.5	34.9	15.9	7/16" - 20 UNF	20,000
SMPC - 6H	3/8"	5.6	25.4	25.4	50.8	50.8	19.1	9/16" - 18 UNF	20,000
SMPC - 9H	9/16"	9.1	31.8	31.8	63.5	63.5	25.4	13/16" - 16 UNF	20,000
SMPC -12H	3/4"	13.1	38.1	38.1	76.2	76.2	34.9	3/4" - 14 NPSM	20,000
SMPC -16H	1"	17.5	52.4	52.4	104.8	104.8	44.5	1-3/8" - 12 UNF	20,000

SMPSC

Straight Coupling

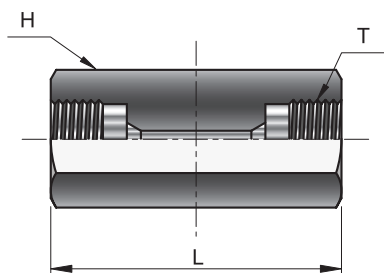

Part No.	Tube Size (in)	Hex H (in)	Orifice	L	T	Pressure Rating (psi)
SMPSC - 4H	1/4"	5/8"	3.2	39.7	7/16" - 20 UNF	20,000
SMPSC - 6H	3/8"	3/4"	5.6	44.5	9/16" - 18 UNF	20,000
SMPSC - 9H	9/16"	1"	9.1	54.0	13/16" - 16 UNF	20,000
SMPSC -12H	3/4"	1 - 3/8"	13.1	63.5	3/4" - 14 NPSM	20,000
SMPSC -16H	1"	1 - 3/4"	17.5	88.9	1-3/8" - 12 UNF	20,000

SMPUC

Union Coupling (Slip Type)

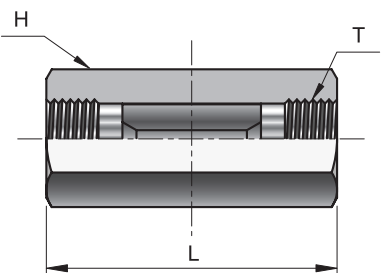

Part No.	Tube Size (in)	Hex H (in)	Orifice	L	T	Pressure Rating (psi)
SMPUC - 4H	1/4"	5/8"	3.2	39.7	7/16" - 20 UNF	20,000
SMPUC - 6H	3/8"	3/4"	5.6	44.5	9/16" - 18 UNF	20,000
SMPUC - 9H	9/16"	1"	9.1	54.0	13/16" - 16 UNF	20,000
SMPUC -12H	3/4"	1 - 3/8"	13.1	63.5	3/4" - 14 NPSM	20,000
SMPUC -16H	1"	1 - 3/4"	17.5	88.9	1-3/8" - 12 UNF	20,000

SMPBC

Bulkhead Coupling

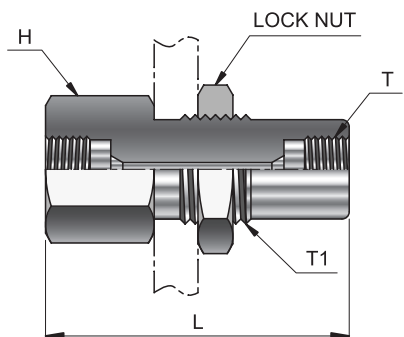

Part No.	Tube Size (in)	Hex H (in)	Orifice	L	T	T1	Pressure Rating (psi)
SMPBC - 4H	1/4"	1"	3.2	47.6	7/16" - 20 UNF	3/4" - 16 UNF	20,000
SMPBC - 6H	3/8"	1"	5.6	50.8	9/16" - 18 UNF	7/8" - 14 UNF	20,000
SMPBC - 9H	9/16"	1-3/8"	9.1	60.3	13/16" - 16 UNF	1-1/16" - 12 UNF	20,000
SMPBC -12H	3/4"	1-7/8"	13.1	66.7	3/4" - 14 NPSM	1-5/8" - 12 UNF	20,000
SMPBC -16H	1"	2-1/8"	17.5	88.9	1-3/8" - 12 UNF	1-7/8" - 12 UNF	20,000

- Dimensions and Drawings are for reference only and are subject to change without prior notice.
- Unless otherwise specified, all dimensions are in millimeters.
- Sizes, pressure classes, and end connections not listed are available upon request.
- Dimensions shown with SUPERLOK nuts finger-tight, where applicable.

SMPCP

Cap

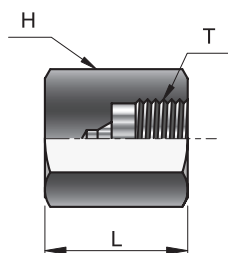

Part No.	Tube Size (in)	Hex H (in)	L	T	Pressure Rating (psi)
SMPCP - 4H	1/4"	5/8"	22.2	7/16" - 20 UNF	20,000
SMPCP - 6H	3/8"	3/4"	34.9	9/16" - 18 UNF	20,000
SMPCP - 9H	9/16"	1"	38.1	13/16" - 16 UNF	20,000
SMPCP - 12H	3/4"	1 - 3/8"	63.5	3/4" - 14 NPSM	20,000
SMPCP - 16H	1"	1 - 3/4"	76.2	1-3/8" - 12 UNF	20,000

SMPN

Nipple

For rapid system make-up, BMT (SUPERLOK) supplies pre-cut, coned-and-threaded nipples in various sizes and lengths for SUPERLOK medium pressure fittings.



Tube Size in (mm)		Part No. Nipple Length in (mm)							Working Pressure at 100°F (psi)
O.D.	I.D.	2.75" (69.9)	3" (76.2)	4" (101.6)	6" (152.4)	8" (203.2)	10" (254)	12" (304.8)	
1/4" (6.35)	0.109" (2.77)	SMPN-4-2.75L	SMPN-4-3L	SMPN-4-4L	SMPN-4-6L	SMPN-4-8L	SMPN-4-10L	SMPN-4-12L	20,000
3/8" (9.53)	0.203" (5.16)		SMPN-6-3L	SMPN-6-4L	SMPN-6-6L	SMPN-6-8L	SMPN-6-10L	SMPN-6-12L	20,000
9/16" (14.29)	0.312" (7.92)			SMPN-9-4L	SMPN-9-6L	SMPN-9-8L	SMPN-9-10L	SMPN-9-12L	20,000
3/4" (19.05)	0.438" (11.13)				SMPN-12-6L	SMPN-12-8L	SMPN-12-10L	SMPN-12-12L	20,000
	0.515" (13.09)				SMPN10-12-6L	SMPN10-12-8L	SMPN10-12-10L	SMPN10-12-12L	10,000
1" (25.4)	0.562" (14.27)				SMPN-16-6L	SMPN-16-8L	SMPN-16-10L	SMPN-16-12L	20,000
	0.687" (17.45)				SMPN10-16-6L	SMPN10-16-8L	SMPN10-16-10L	SMPN10-16-12L	10,000

• Part Number specify 316 stainless steel material. Other materials are available upon request.

- Dimensions and Drawings are for reference only and are subject to change without prior notice.
- Unless otherwise specified, all dimensions are in millimeters.
- Sizes, pressure classes, and end connections not listed are available upon request.
- Dimensions shown with SUPERLOK nuts finger-tight, where applicable.

Anti-vibration Collet Gland - Pressure up to 20,000psi

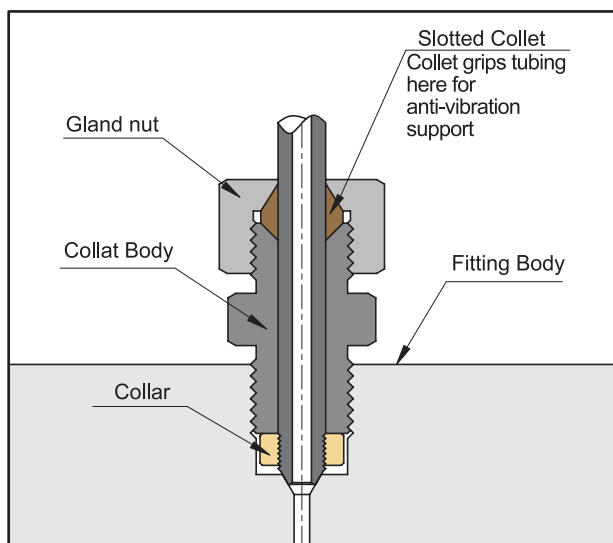

For extreme conditions of vibration and/or shock in tubing systems such as an unsupported line near a compressor, coned and threaded connections are offered with the SUPERLOK anti-vibration collet gland assembly. Completely interchangeable with standard SUPERLOK medium pressure connections, the collet gland assembly provides equally effective pressure handling capability. In standard connection systems, the bending stresses on the threaded area of the tubing imposed by excessive vibration or movement may cause premature fatigue failure of the tubing at the back of the thread. By moving the stress concentration back to the unthreaded part of the tubing and providing a wedge-type gripping action, the SUPERLOK anti-vibration collet gland assembly strengthens the entire structure. With stress concentration reduced and overall stress level maintained well below the endurance limit of the material, virtually unlimited vibrational fatigue life can be attained.

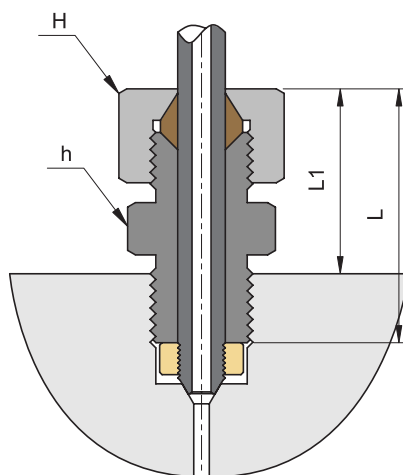

Part No.	Tube Size (in)	Hex H (in)		L1	L	Collar
		h	H			
SMP-AVCG- 4H	1/4"	1/2"	5/8"	23.9	30.2	SMPCR- 4
SMP-AVCG- 6H	3/8"	5/8"	3/4"	30.2	38.1	SMPCR- 6
SMP-AVCG- 9H	9/16"	7/8"	7/8"	35.8	45.2	SMPCR- 9
SMP-AVCG-12H	3/4"	1 - 1/8"	1 - 1/8"	40.4	50.8	SMPCR-12
SMP-AVCG-16H	1"	1 - 3/8"	1 - 3/8"	42.9	60.5	SMPCR-16

- Dimensions and Drawings are for reference only and are subject to change without prior notice.
- Unless otherwise specified, all dimensions are in millimeters.
- Sizes, pressure classes, and end connections not listed are available upon request.
- Dimensions shown with SUPERLOK nuts finger-tight, where applicable.

High Pressure Fittings

SHP Series - 60,000 psi (4137 bar)

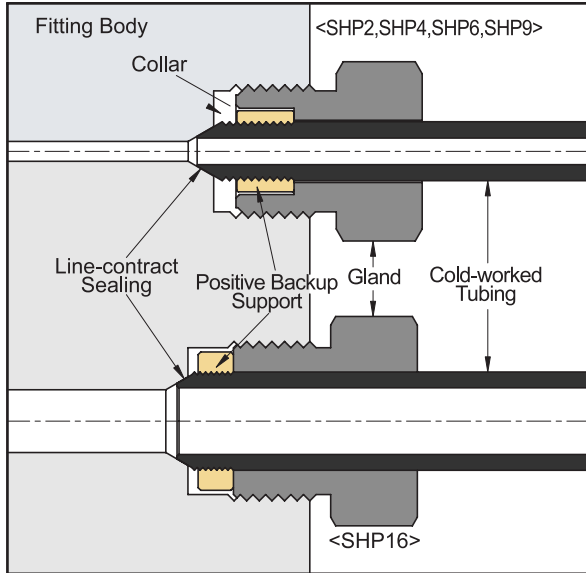

Features

- Pressure: up to 60,000 psi (4137 bar)
- Increased pressure handling capabilities.
- Coned and Threaded connection.
- Available sizes: 1/8", 1/4", 3/8", 9/16", and 1" .
- Fittings manufactured from cold worked 316 stainless steel.
- Operating temperatures: -423°F (-252°C) to 1200°F (649°C)
- Anti-vibration connection components available.

Tube Size & end Dimension

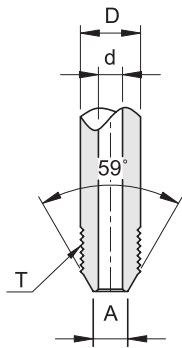

Tube Size mm				Flow Area mm ²	Working Pressure (psi)				
O.D (D)	I.D (d)	A	Thread (T)		-325 to 100°F (-198 to 37.8°C)	200°F (93°C)	400°F (204°C)	600°F (316°C)	800°F (427°C)
1/8" (3.18)	0.51	1.59	1/8" - 40 L.H.	0.203	60,000	60,000	57,750	54,250	50,700
1/4" (6.35)	2.77	3.18	1/4" - 28 L.H.	3.23	60,000	60,000	57,750	54,250	50,700
3/8" (9.53)	5.16	5.56	3/8" - 24 L.H.	7.74	60,000	60,000	57,750	54,250	50,700
9/16" (14.29)	4.78	7.14	9/16" - 18 L.H.	18.06	60,000	60,000	57,750	54,250	50,700
	6.35			30.97	40,000	40,000	38,500	36,100	33,800
1" (25.40)	11.13	14.29	1" - 14 L.H.	97.42	43,000	43,000	43,000	41,380	36,330

SHPG

Gland

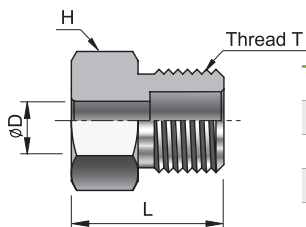

Part No.	Tube Size (in)	Hex H (in)	D	L	T	Pressure Rating (psi)
SHPG - 2H	1/8"	1/2"	3.2	19.1	1/2" - 20 UNF	60,000
SHPG - 4H	1/4"	5/8"	6.4	20.6	9/16" - 18 UNF	60,000
SHPG - 6H	3/8"	13/16"	9.5	23.8	3/4" - 16 UNF	60,000
SHPG - 9H	9/16"	1-3/16"	14.3	34.9	1-1/8" - 12 UNF	60,000
SHPG40 - 9H	9/16"	1-3/16"	14.3	34.9	1-1/8" - 12 UNF	40,000
SHPG30 - 16H	1"	1-3/8"	25.4	38.1	1-3/8" - 12 UNF	30,000

- Dimensions and Drawings are for reference only and are subject to change without prior notice.
- Unless otherwise specified, all dimensions are in millimeters.
- Sizes, pressure classes, and end connections not listed are available upon request.
- Dimensions shown with SUPERLOK nuts finger-tight, where applicable.

SHPCR

Collar

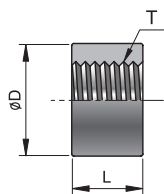

Part No.	Tube Size (in)	D	L	Thread T	Pressure Rating (psi)
SHPCR - 2H	1/8"	6.4	7.9	1/8" - 40 L.H.	60,000
SHPCR - 4H	1/4"	9.5	9.5	1/4" - 28 L.H.	60,000
SHPCR - 6H	3/8"	12.7	13.5	3/8" - 24 L.H.	60,000
SHPCR - 9H	9/16"	20.6	15.9	9/16" - 18 L.H.	60,000
SHPCR40 - 9H	9/16"	20.6	15.9	3/4" - 16 L.H.	40,000
SHPCR30 -16H	1"	31.8	12.7	1" - 14 L.H.	30,000

SHPP

Plug

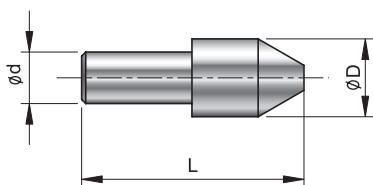

Part No.	Tube Size (in)	d	D	L	Pressure Rating (psi)
SHPP - 2H	1/8"	3.2	6.4	22.2	60,000
SHPP - 4H	1/4"	6.4	9.5	28.6	60,000
SHPP - 6H	3/8"	9.5	12.7	33.3	60,000
SHPP - 9H	9/16"	14.3	20.6	44.5	60,000

SHPE

Elbow

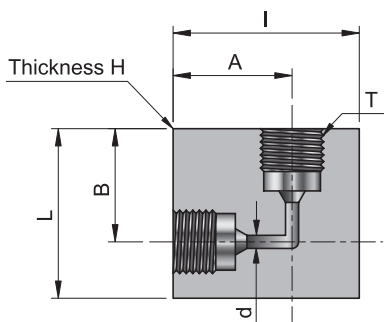

Part No.	Tube Size (in)	d	A	B	I	L	H	T	Pressure Rating (psi)
SHPE - 2H	1/8"	1.2	19.1	19.1	28.6	28.6	19.1	1/2" - 20 UNF	60,000
SHPE - 4H	1/4"	2.4	22.2	25.4	34.9	38.1	25.4	9/16" - 18 UNF	60,000
SHPE - 6H	3/8"	4.8	31.8	25.4	44.5	38.1	25.4	3/4" - 16 UNF	60,000
SHPE - 9H	9/16"	6.4	47.6	28.6	66.7	47.6	38.1	1-1/8" - 12 UNF	60,000
SHPE40 - 9H	9/16"	6.4	47.6	28.6	66.7	47.6	38.1	1-1/8" - 12 UNF	40,000
SHPE30 -16H	1"	11.1	52.4	52.4	76.2	76.2	44.5	1-3/8" - 12 UNF	30,000

- Dimensions and Drawings are for reference only and are subject to change without prior notice.
- Unless otherwise specified, all dimensions are in millimeters.
- Sizes, pressure classes, and end connections not listed are available upon request.
- Dimensions shown with SUPERLOK nuts finger-tight, where applicable.

SHPT

Tee

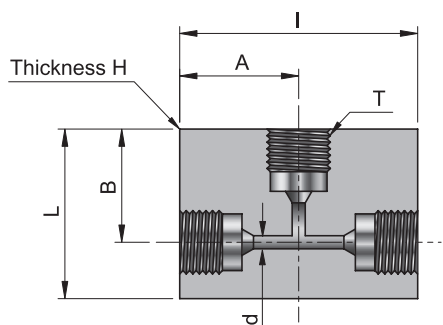

Part No.	Tube Size (in)	d	A	B	I	L	H	T	Pressure Rating (psi)
SHPT - 2H	1/8"	1.2	19.1	17.5	38.1	28.6	19.1	1/2" - 20 UNF	60,000
SHPT - 4H	1/4"	2.4	25.4	25.4	50.8	34.9	25.4	9/16" - 18 UNF	60,000
SHPT - 6H	3/8"	4.8	25.4	31.8	50.8	39.7	25.4	3/4" - 16 UNF	60,000
SHPT - 9H	9/16"	6.4	33.3	34.9	66.7	54.0	38.1	1-1/8" - 12 UNF	60,000
SHPT40 - 9H	9/16"	6.4	33.3	34.9	66.7	54.0	38.1	1-1/8" - 12 UNF	40,000
SHPT30 -16H	1"	11.1	52.4	52.4	104.8	76.2	44.5	1-3/8" - 12 UNF	30,000

SHPC

Cross

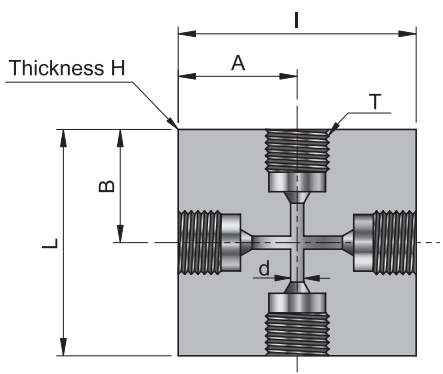

Part No.	Tube Size (in)	d	A	B	I	L	H	T	Pressure Rating (psi)
SHPC - 2H	1/8"	1.2	19.1	19.1	38.1	38.1	19.1	1/2" - 20 UNF	60,000
SHPC - 4H	1/4"	2.4	25.4	19.1	50.8	38.1	25.4	9/16" - 18 UNF	60,000
SHPC - 6H	3/8"	4.8	27.0	25.4	54.0	50.8	25.4	3/4" - 16 UNF	60,000
SHPC - 9H	9/16"	6.4	34.9	33.3	69.9	66.7	38.1	1-1/8" - 12 UNF	60,000
SHPC40 - 9H	9/16"	6.4	34.9	33.3	69.9	66.7	38.1	1-1/8" - 12 UNF	40,000
SHPC30 -16H	1"	11.1	52.4	52.4	104.8	104.8	44.5	1-3/8" - 12 UNF	30,000

SHPSC

Straight Coupling

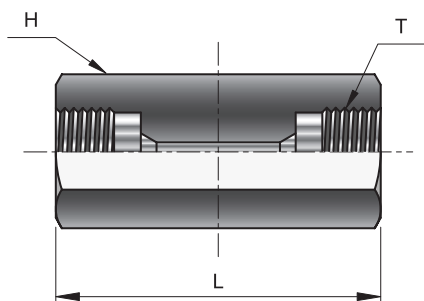

Part No.	Tube Size (in)	Hex H (in)	Orifice	L	T	Pressure Rating (psi)
SHPSC - 2H	1/8"	3/4"	1.2	28.6	1/2" - 20 UNF	60,000
SHPSC - 4H	1/4"	1"	2.4	44.5	9/16" - 18 UNF	60,000
SHPSC - 6H	3/8"	1"	4.8	50.8	3/4" - 16 UNF	60,000
SHPSC - 9H	9/16"	1 - 3/8"	6.4	60.3	1-1/8" - 12 UNF	60,000
SHPSC40 - 9H	9/16"	1 - 3/8"	6.4	60.3	1-1/8" - 12 UNF	40,000
SHPSC30 -16H	1"	1 - 3/4"	11.1	88.9	1-3/8" - 12 UNF	30,000

- Dimensions and Drawings are for reference only and are subject to change without prior notice.
- Unless otherwise specified, all dimensions are in millimeters.
- Sizes, pressure classes, and end connections not listed are available upon request.
- Dimensions shown with SUPERLOK nuts finger-tight, where applicable.

SHPUC

Union Coupling (Slip Type)

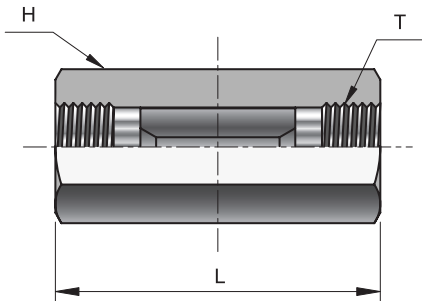

Part No.	Tube Size (in)	Hex H (in)	Orifice	L	T	Pressure Rating (psi)
SHPUC - 2H	1/8"	3/4"	1.2	28.6	1/2" - 20 UNF	60,000
SHPUC - 4H	1/4"	1"	2.4	44.5	9/16" - 18 UNF	60,000
SHPUC - 6H	3/8"	1"	4.8	50.8	3/4" - 16 UNF	60,000
SHPUC - 9H	9/16"	1 - 3/8"	6.4	60.3	1-1/8" - 12 UNF	60,000
SHPUC40 - 9H	9/16"	1 - 3/8"	6.4	60.3	1-1/8" - 12 UNF	40,000
SHPUC30 - 16H	1"	1 - 3/4"	11.1	88.9	1-3/8" - 12 UNF	30,000

SHPBC

Bulkhead Coupling

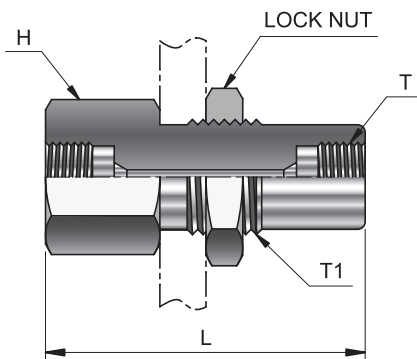

Part No.	Tube Size (in)	Hex H (in)	Orifice	L	T	T1	Pressure Rating (psi)
SHPBC - 2H	1/8"	1"	1.2	46.0	1/2" - 20 UNF	7/8" - 14 UNF	60,000
SHPBC - 4H	1/4"	1"	2.4	50.8	9/16" - 18 UNF	7/8" - 14 UNF	60,000
SHPBC - 6H	3/8"	1-3/8"	4.8	60.3	3/4" - 16 UNF	1-1/16" - 12 UNF	60,000
SHPBC - 9H	9/16"	1-7/8"	6.4	69.9	1-1/8" - 12 UNF	1-5/8" - 12 UNF	60,000
SHPBC40 - 9H	9/16"	1-7/8"	6.4	69.9	1-1/8" - 12 UNF	1-5/8" - 12 UNF	40,000
SHPBC30 - 16H	1"	1-7/8"	11.1	88.9	1-3/8" - 12 UNF	2-1/8" - 12 UNF	30,000

SHPCP

Cap

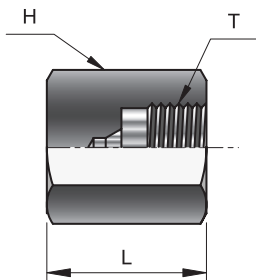

Part No.	Tube Size (in)	Hex H (in)	L	T	Pressure Rating (psi)
SHPCP - 2H	1/8"	3/4"	22.2	1/2" - 20 UNF	60,000
SHPCP - 4H	1/4"	3/4"	22.2	9/16" - 18 UNF	60,000
SHPCP - 6H	3/8"	1"	31.8	3/4" - 16 UNF	60,000
SHPCP - 9H	9/16"	1 - 3/8"	38.1	1-1/8" - 12 UNF	60,000
SHPCP40 - 9H	9/16"	1 - 3/8"	38.1	1-1/8" - 12 UNF	40,000
SHPCP30 - 16H	1"	1 - 3/4"	76.2	1-3/8" - 12 UNF	30,000

- Dimensions and Drawings are for reference only and are subject to change without prior notice.
- Unless otherwise specified, all dimensions are in millimeters.
- Sizes, pressure classes, and end connections not listed are available upon request.
- Dimensions shown with SUPERLOK nuts finger-tight, where applicable.

SHPN
Nipple

For rapid system make-up, BMT (SUPERLOK) supplies precut, coned-and-threaded nipples in various sizes and lengths for SUPERLOK high pressure fittings.



Tube Size in (mm)		Part No.							Working Pressure at 100°F (psi)
		Nipple Length in (mm)							
O.D.	I.D.	2.75" (69.9)	3" (76.2)	4" (101.6)	6" (152.4)	8" (203.2)	10" (254)	12" (304.8)	
1/8" (3.18)	0.020" (0.51)	SHPN-4-2.75L	SHPN-2-3L	SHPN-2-4L	SHPN-2-6L	SHPN-2-8L	SHPN-2-10L	SHPN-2-12L	60,000
1/4" (6.35)	0.083" (2.11)	SHPN-4-2.75L	SHPN-4-3L	SHPN-4-4L	SHPN-4-6L	SHPN-4-8L	SHPN-4-10L	SHPN-4-12L	60,000
3/8" (9.53)	0.125" (3.18)		SHPN-6-3L	SHPN-6-4L	SHPN-6-6L	SHPN-6-8L	SHPN-6-10L	SHPN-6-12L	60,000
9/16" (14.29)	0.188" (4.78)			SHPN-9-4L	SHPN-9-6L	SHPN-9-8L	SHPN-9-10L	SHPN-9-12L	60,000
	0.250" (6.35)			SHPN40-9-4L	SHPN40-9-6L	SHPN40-9-8L	SHPN40-9-10L	SHPN40-9-12L	40,000
1" (25.4)	0.437" (11.09)				SHPN30-16-6L	SHPN30-16-8L	SHPN30-16-10L	SHPN30-16-12L	30,000

• Part Number specify 316 stainless steel material. Other materials are available upon request.

- Dimensions and Drawings are for reference only and are subject to change without prior notice.
- Unless otherwise specified, all dimensions are in millimeters.
- Sizes, pressure classes, and end connections not listed are available upon request.
- Dimensions shown with SUPERLOK nuts finger-tight, where applicable.

Anti-vibration Collet Gland - Pressure up to 60,000psi

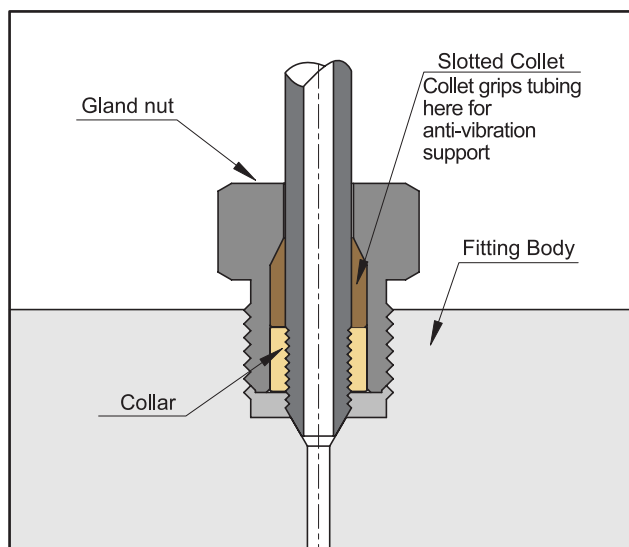

For extreme conditions of vibration and/or shock in tubing system such as locating fitting on an unsupported line near a compressor, SUPERLOK coned and threaded connections are offered with the anti-vibration collet gland assemblies. Completely interchangeable with standard SUPERLOK high pressure connections, the collet gland assemblies provide equally effective pressure handling capability.

In standard connection systems, the bending stresses on the threaded area of the tubing imposed by excessive vibration or movement may cause premature fatigue failure of the tubing at the back of the thread. By moving the stress concentration back to the unthreaded part of the tubing and providing a wedge-type gripping action, the SUPERLOK anti-vibration collet gland assembly strengthens the entire structure. With stress concentration reduced and overall stress level maintained well below the endurance limit of the material, virtually unlimited vibrational fatigue life can be attained.

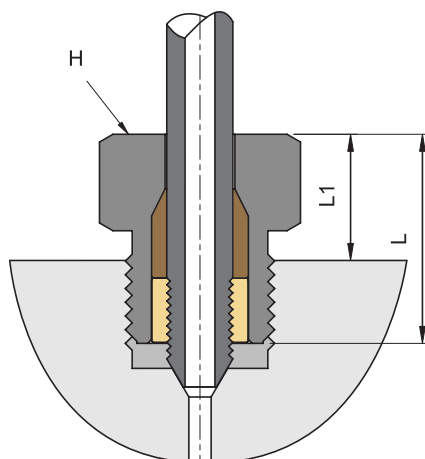

Part No.	Tube Size (in)	Hex H (in)	L1	L
SHP- AVCG- 4H	1/4"	5/8"	12.7	20.6
SHP- AVCG- 6H	3/8"	7/8"	15.8	28.5
SHP- AVCG- 9H	9/16"	1 - 3/16"	25.4	30.2

- Dimensions and Drawings are for reference only and are subject to change without prior notice.
- Unless otherwise specified, all dimensions are in millimeters.
- Sizes, pressure classes, and end connections not listed are available upon request.
- Dimensions shown with SUPERLOK nuts finger-tight, where applicable.

Anti-vibration Collet Gland - Pressure up to 43,000psi

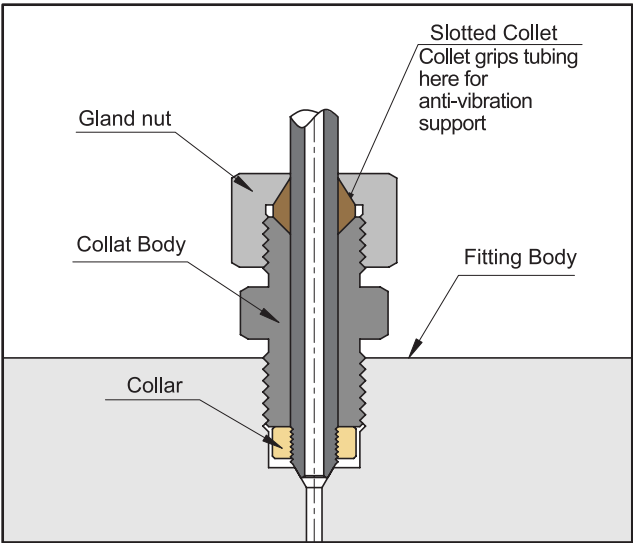

For extreme conditions of vibration and/or shock in tubing system, such as locating fitting on an unsupported line near a compressor, SUPERLOK coned and threaded connections are offered with the anti-vibration collet gland assemblies. A less complex and more economical design than other vibration-resistant connections, the collet gland assembly utilizes the same coned and threaded features of SUPERLOK high pressure connections. SHP-AVCG-16H extends gland nut to provide room for the tapered, slotted collet and collet nut. The design provides a slight difference in angles between the collet and the corresponding taper of the gland nut. As the nut is tightened, it acts to wedge the tapered end of the collet into a gripping engagement with the tubing.

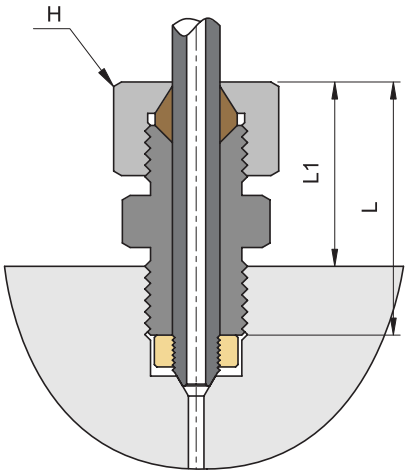

Part No.	Tube Size (in)	Hex H (in)	L1	L
SHP- AVCG- 16H	1 "	1 - 1/2"	42.9	60.5

- Dimensions and Drawings are for reference only and are subject to change without prior notice.
- Unless otherwise specified, all dimensions are in millimeters.
- Sizes, pressure classes, and end connections not listed are available upon request.
- Dimensions shown with SUPERLOK nuts finger-tight, where applicable.

Installation Instructions

Medium Pressure and High Pressure Coned and Threaded Tube Connections

1. Apply a process-compatible lubricant to the gland threads.
2. Slip the gland onto the tube, then thread the collar onto the tube end.
3. A small amount of process-compatible lubricant applied to the tube cone will facilitate sealing. Insert the tubing into the connection and tighten finger tight.
4. Tighten gland slightly with the wrench.

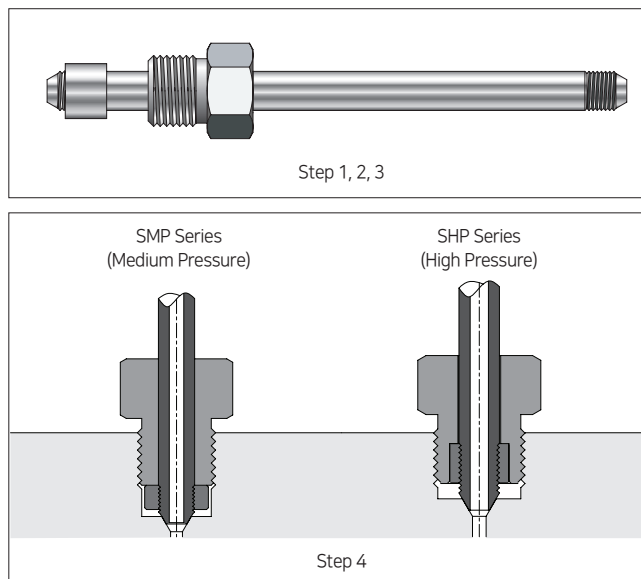

Ordering Information

Example :

SMPG - 8H

1 2

* 316 Stainless Steel is Standard Body Material.

1. Pressure & Type of Fitting

Please refer to High Pressure Fitting Index on page 2.

Example:

- ☐ **SMPG** = Medium Pressure, Gland
- ☐ **SHPN** = High Pressure, Nipple

2. Size of Fitting (Tube O.D)

Fractional Tube	OD (inch)	1/4	3/8	9/16	3/4	1
	Designator	4H	6H	9H	12H	16H

※ For special sizes and configurations, please consult BMT (SUPERLOK) sales representative.



BMT Co., Ltd.

| Head Quarter & 1st Factory

(50568) 경상남도 양산시 산막공단남11길 35 (북정동)

35, Sanmakgongdannam 11-gil, Yangsan-si, Gyeongsangnam-do, 50568, South Korea

TEL: +82 55 783 1000 FAX: +82 55 783 1111

E-mail: superlok@superlok.com

| 2nd Factory

(50568) 경상남도 양산시 산막공단남8길 29 (호계동)

29, Sanmakgongdannam 8-gil, Yangsan-si, Gyeongsangnam-do, 50568, South Korea

Fittings & Valves

INDUSTRIAL

Instrumentation Tube Fittings

i-Fitting®

Ball/Plug Valves

Double Block & Bleed Valves

Manifold/Gauge Valves

Globe/Needle Valves

Cryogenic Valves

Check/Relief/Excess Flow Valves

High Pressure Valves

ULTRA HIGH PURITY

Weld & Metal Face Seal Fittings

Bend Fittings

Diaphragm Valves

Bellows Valves

Check Valves

Clean Ball Valves

Regulators

Electric & Energy

PRODUCT & SOLUTION

Compact Switchboard

Motor Control Center (MCC)

Smart Distribution Board

Energy Management System (EMS)

COMPONENTS (BMT PATENTED)

MCBS (Molded Case Busbar System)

MCPD (Molded Case Power Distributor)

Smart-eye (AC/DC Meter)